

MULTI-CAISSES



SIMULTANEOUS INTERPRETATION BOOTH SYSTEMS

TECHNICAL SPECIFICATION: **PB-8001 PROTOCOLE**
STANDARD DIMENSIONS OUTSIDE: 257,1 cm X 199,5 cm X 173,5 cm
ACOUSTIC ENVIRONMENT: Surpasses ISO-4043 International standard (last revision)

PHYSICAL DIMENSION 13 panels PB-8001

STANDARD	DIMENSION	WEIGHT
Standard panel (4)	85,7 cm X 199,1 cm	6,82 Kg
Window panel (5)	85,7 cm X 199,1 cm	7,46 Kg
Door panel (1)	85,7 cm X 199,1 cm	9,25 Kg
Roof panel (3)	85,7 cm X 173,5 cm	5,76 Kg
Total booth Weight		91,11 Kg

* Standard outside color: Dark grey or light grey (ABS plastic finish)

* Standard inside color: Light grey or dark blue

Assembly: No tools are required

Approx. Assembly time: 10 minutes
(2 persons)

Storage & shipping: Included (2) ATA-300 shipping cases on wheels (105 Kg for 2 cases)

Air ventilation: Included (2) H.D. 55 CFM silent whisper 110 volts fan assembly unit
CSA approved with (2) electric outlet for accessories

Options: Easy install working table, double Plexiglass window, air conditioning
Sound proof flooring, interior partition systems, custom size built

Construction Each panel is built with an ABS plastic exterior with special isolated soundproof fibreglass panel. Material is fire retardant UL-723 inside covering is made with decorative textile 100% polyester. Cotton of 9mm. Woven density and weight of 60 gr. Per meter. Framing is PVC extrusion with unique connecting concept with industrial velcro for easy assembly without any tools.



www.multi-caisses.com info@multi-caisses.com

350, Rue Fortin, Vanier (Québec) Canada G1M 1B1 Tél.: (418) 527-2549 1-800-463-2549 Fax.: (418) 527-5856
1-800-463-5856 www.multi-caisses.com CaisSES et coffres de transport/ Carrying and shipping cases
Cabines de traduction simultanée/ Whisper Cube Québec Canada USA

MULTI-CAISSES



SIMULTANEOUS INTERPRETATION BOOTH SYSTEMS

TECHNICAL SPECIFICATION: **PB-8002 PROTOCOLE**
STANDARD DIMENSIONS OUTSIDE: 171,4 cm X 199,5 cm X 173,5 cm
ACOUSTIC ENVIRONMENT: Surpasses ISO-4043 International standard (last revision)

PHYSICAL DIMENSION 10 panels PB-8002

STANDARD	DIMENSION	WEIGHT
Standard panel (3)	85,7 cm X 199,1 cm	6,82 Kg
Window panel (4)	85,7 cm X 199,1 cm	7,46 Kg
Door panel (1)	85,7 cm X 199,1 cm	9,25 Kg
Roof panel (2)	85,7 cm X 173,5 cm	5,76 Kg
Total booth Weight		70,97kg

* Standard outside color: Dark grey or light grey (ABS plastic finish)

* Standard inside color: Light grey or dark blue

Assembly: No tools are required

Approx. Assembly time:
(2 persons) 10 minutes

Storage & shipping Included (1) ATA-300 shipping case on wheels (52,5 Kg)

Air ventilation Included (2) H.D. 55 CFM silent whisper 110 volts fan assembly unit
CSA approved with (2) electric outlet for accessories

Options: Each install working table, double Plexiglass window, air conditioning
Sound proof flooring, interior division partition systems.

Construction Each panel is built with an ABS plastic exterior with special isolated
soundproof fibreglass panel. Material is fire retardant UL-723 inside
covering is made with decorative textile 100% polyester. Cotton of 9mm.
Woven density and weight of 60 gr. Per meter. Framing is PVC extrusion
with unique connecting concept with industrial velcro for easy
assembly without any tools.



www.multi-caisses.com info@multi-caisses.com

350, Rue Fortin, Vanier (Québec) Canada G1M 1B1 Tél.: (418) 527-2549 1-800-463-2549 Fax.: (418) 527-5856
1-800-463-5856 www.multi-caisses.com Caisses et coffres de transport/ Carrying and shipping cases
Cabines de traduction simultanée/ Whisper Cube Québec Canada USA

MULTI-CAISSES



SIMULTANEOUS INTERPRETATION BOOTH SYSTEMS

TECHNICAL SPECIFICATION: **PB-8003 DIPLOMATE**
STANDARD DIMENSIONS OUTSIDE: 171,4 cm X 199,5 cm X 173,5 cm
ACOUSTIC ENVIRONMENT: Surpasses ISO-4043 International standard (last revision)

PHYSICAL DIMENSION 10 panels PB-8003

STANDARD	DIMENSION	WEIGHT
Standard panel (3)	85,7 cm X 199,1 cm	6,82 Kg
Window panel (4)	85,7 cm X 199,1 cm	7,46 Kg
Door panel (1)	85,7 cm X 199,1 cm	9,25 Kg
Roof panel (2)	85,7 cm X 173,5 cm	5,76 Kg
Total booth Weight		70,97 Kg

* Standard outside color: Oak or Mahogany

* Standard inside color: Light grey or dark blue

Assembly: No tools are required

Approx. Assembly time: 10 minutes
(2 persons)

Storage & shipping: Included (1) ATA-300 shipping case on wheels (52,5 Kg)

Air ventilation: Included (2) H.D. 55 CFM silent whisper 110 volts fan assembly unit
CSA approved with (2) electric outlet for accessories

Options: Install working table, double Plexiglass window, air conditioning
Sound proof flooring, interior division partition systems.

Construction Each panel is built with an wood finish laminate, exterior with special
isolated soundproof fibreglass panel. Materiel is fire retardant
UL-723 inside covering is made with decorative textile 100% polyester.
Cotton of 9mm with unique connecting concept with industrial velcro
for easy assembly without any tools.



www.multi-caisses.com info@multi-caisses.com

350, Rue Fortin, Vanier (Québec) Canada G1M 1B1 Tél.: (418) 527-2549 1-800-463-2549 Fax.: (418) 527-5856
1-800-463-5856 www.multi-caisses.com Caisse et coffres de transport/ Carrying and shipping cases
Cabines de traduction simultanée/ Whisper Cube Québec Canada USA

MULTI-CAISSES



SIMULTANEOUS INTERPRETATION BOOTH SYSTEMS

TECHNICAL SPECIFICATION: **TB-0064 WHISPER CUBE**

STANDARD DIMENSIONS OUTSIDE: 244 cm X 207 cm X 184,3 cm

ACOUSTIC ENVIRONMENT: meet ISO 4043 - ISO-2603

PHYSICAL DIMENSION

18 panels TB-0064

STANDARD	DIMENSION	WEIGHT
Standard panel (7)	61 cm X 207 cm	7,5 Kg
Window panel (6)	61 cm X 207 cm	8,1 Kg
Door panel (1)	61 cm X 207 cm	8,7 Kg
Roof panel (4)	61 cm X 184,3 cm	6,5 Kg
Total booth Weight		135,8 Kg

* Standard outside color: Light grey

* Standard inside color: Dark blue

***Other colours available on request with additional cost

Assembly: No tools are required

Approx. Assembly time: 10 minutes
(2 persons)

Storage & shipping: Included (2) ATA-300 shipping cases on wheels (105 Kg for 2 cases)

Air ventilation: Included (2) H.D. 55 CFM silent whisper 110 volts fan assembly unit
CSA approved with (2) electric outlet for accessories

Options: Easy install working table, double Plexiglass window, air conditioning
Sound proof flooring, interior partition systems, custom size built

Construction

Each panel are build with an exterior covering of expanded vinyl with a special sound barrier of acoustic foam and MIL-B131-H laminating aluminium foil. The inside covering is made with decorative 100% polyester cotton 9mm woven density, framing is high density PVC extrusion with Velcro no tools request for assembly.



www.multi-caisses.com info@multi-caisses.com

350, Rue Fortin, Vanier (Québec) Canada G1M 1B1 Tél.: (418) 527-2549 1-800-463-2549 Fax.: (418) 527-5856
1-800-463-5856 www.multi-caisses.com Caisses et coffres de transport/ Carrying and shipping cases
Cabines de traduction simultanée/ Whisper Cube Québec Canada USA

MULTI-CAISSES



SIMULTANEOUS INTERPRETATION BOOTH SYSTEMS

TECHNICAL SPECIFICATION: **TB-0066 WHISPER CUBE**
STANDARD DIMENSIONS OUTSIDE: 183 cm X 207 cm X 184,3 cm
ACOUSTIC ENVIRONMENT: meet ISO 4043 - ISO-2603

PHYSICAL DIMENSION 15 panels TB-0066

STANDARD	DIMENSION	WEIGHT
Standard panel (6)	61 cm X 207 cm	7,5 Kg
Window panel (5)	61 cm X 207 cm	8,1 Kg
Door panel (1)	61 cm X 207 cm	8,7 Kg
Roof panel (4)	61 cm X 184,3 cm	6,5 Kg
Total booth Weight		113,7 Kg

* Standard outside color: Light grey

* Standard inside color: Dark blue

***Other colours available on request with additional cost

Assembly: No tools are required

Approx. Assembly time: 10 minutes
(2 persons)

Storage & shipping Included (2) ATA-300 shipping cases on wheels (105 Kg for 2 cases)

Air ventilation Included (2) H.D. 55 CFM silent whisper 110 volts fan assembly unit
CSA approved with (2) electric outlet for accessories

Options: Easy install working table, double Plexiglass window, air conditioning
Sound proof flooring, interior partition systems, custom size built

Construction Each panel are build with an exterior covering of expanded vinyl with a special sound barrier of acoustic foam and MIL-B131-H laminating aluminium foil. The inside covering is made with decorative 100% polyester cotton 9mm woven density, framing is high density PVC extrusion with Velcro no tools request for assembly.



www.multi-caisses.com info@multi-caisses.com

350, Rue Fortin, Vanier (Québec) Canada G1M 1B1 Tél.: (418) 527-2549 1-800-463-2549 Fax.: (418) 527-5856
1-800-463-5856 www.multi-caisses.com Caisse et coffres de transport/ Carrying and shipping cases
Cabines de traduction simultanée/ Whisper Cube Québec Canada USA

MULTI-CAISSES



SIMULTANEOUS INTERPRETATION BOOTH SYSTEMS

TECHNICAL SPECIFICATION: **TB-0070**
STANDARD DIMENSIONS OUTSIDE: 120 cm X 61 cm X 61 cm
ACOUSTIC ENVIRONMENT: no results available

PHYSICAL DIMENSION

STANDARD	DIMENSION
2 Panels (portable)	220 cm X 61 cm X 61 cm
Total booth Weight	24,5 Kg

* Standard outside color: Light grey

* Standard inside color: Dark blue

***Other colours available on request with additional cost

Assembly: No tools are required

Approx. Assembly time:
(1 person) 5 minutes

Storage & shipping Soft side carrying case

Air ventilation Open back

Options: Double Plexiglass ATA shipping case

Construction

Total panels are build with an exterior covering of expanded vinyl with a special sound barrier of acoustic foam and MIL-B131-H laminating aluminium foil. The inside covering is made with decorative 100% polyester cotton 9mm woven density, framing is high density PVC extrusion with Velcro no tools request for assembly.



www.multi-caisses.com info@multi-caisses.com

350, Rue Fortin, Vanier (Québec) Canada G1M 1B1 Tél.: (418) 527-2549 1-800-463-2549 Fax.: (418) 527-5856
1-800-463-5856 www.multi-caisses.com Caisses et coffres de transport/ Carrying and shipping cases
Cabines de traduction simultanée/ Whisper Cube Québec Canada USA



DESIGN

MULTI-CAISSES



CONFIGURATION

PROTOCOLE PB-8001

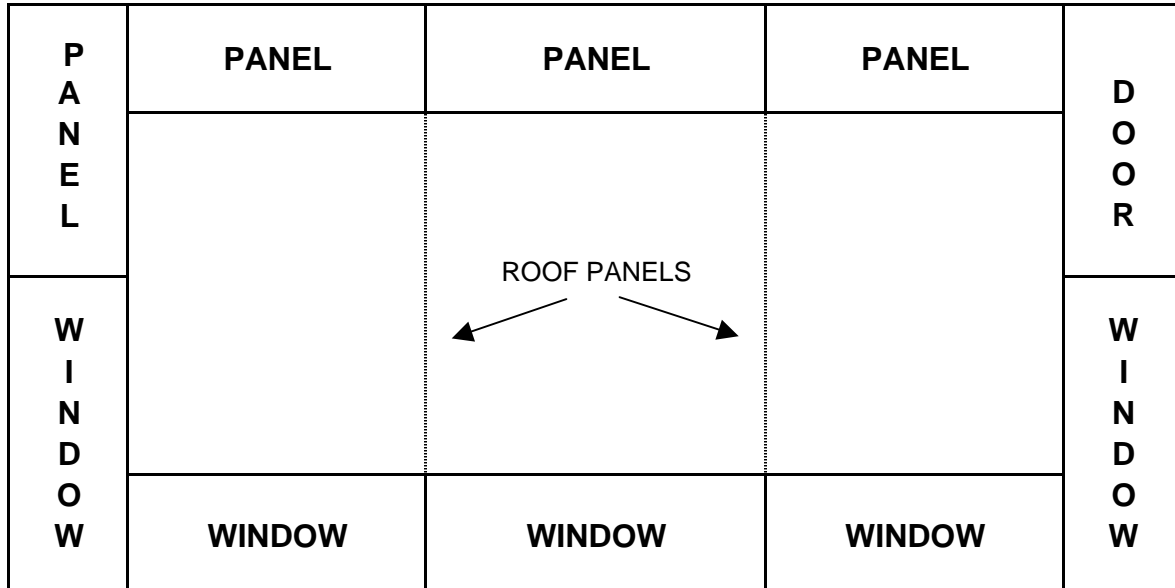

FRONT

PROTOCOLE PB-8002

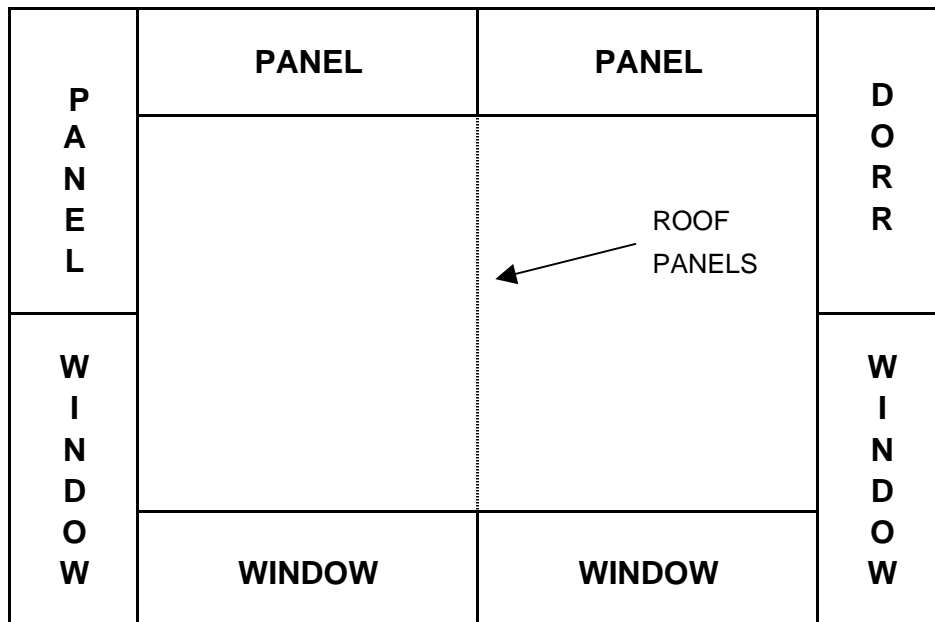

*** NOTE DOOR PANEL CAN BE FIT ON RIGHT OR LEFT SIDE



MULTI-CAISSES



DESIGN

CONFIGURATION

DIPLOMATE PB-8003

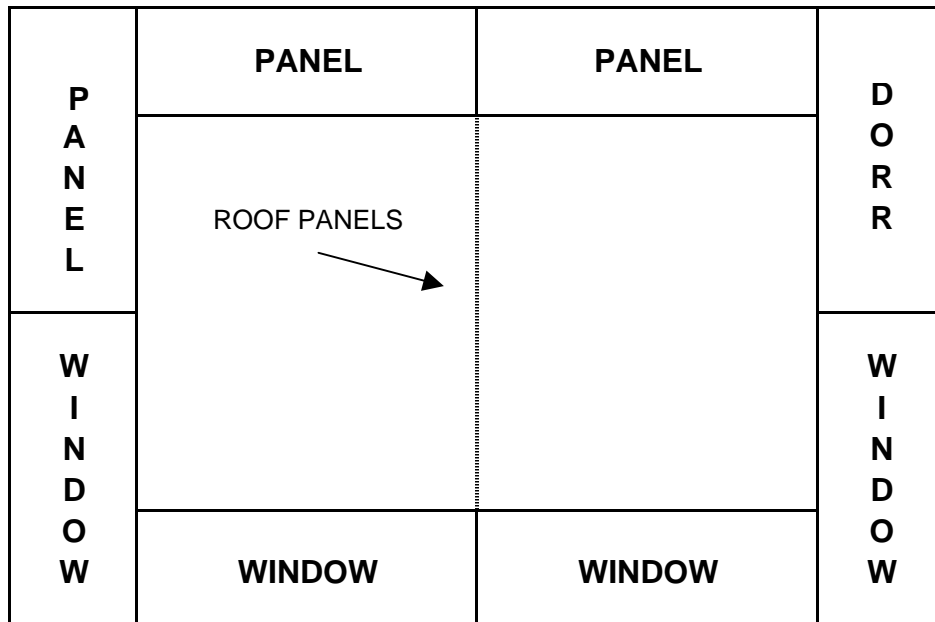

*** NOTE DOOR PANEL CAN BE FIT ON RIGHT OR LEFT SIDE



MULTI-CAISSES



DESIGN

CONFIGURATION

TB-0064

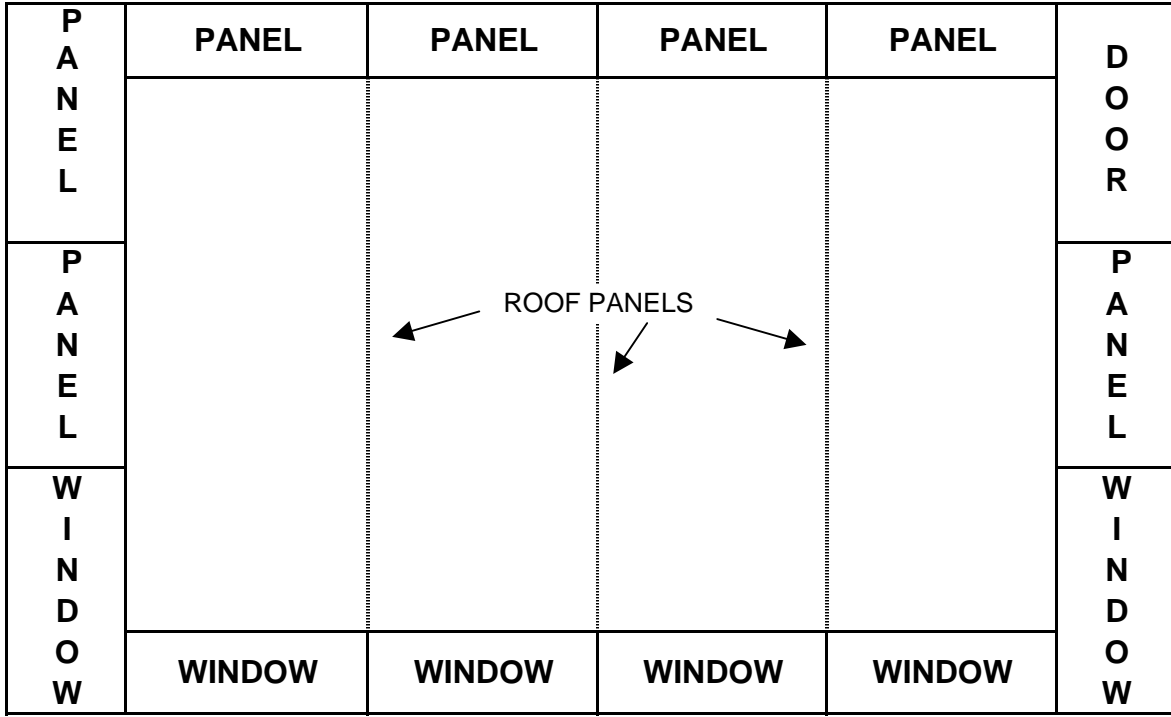

FRONT

TB-0066

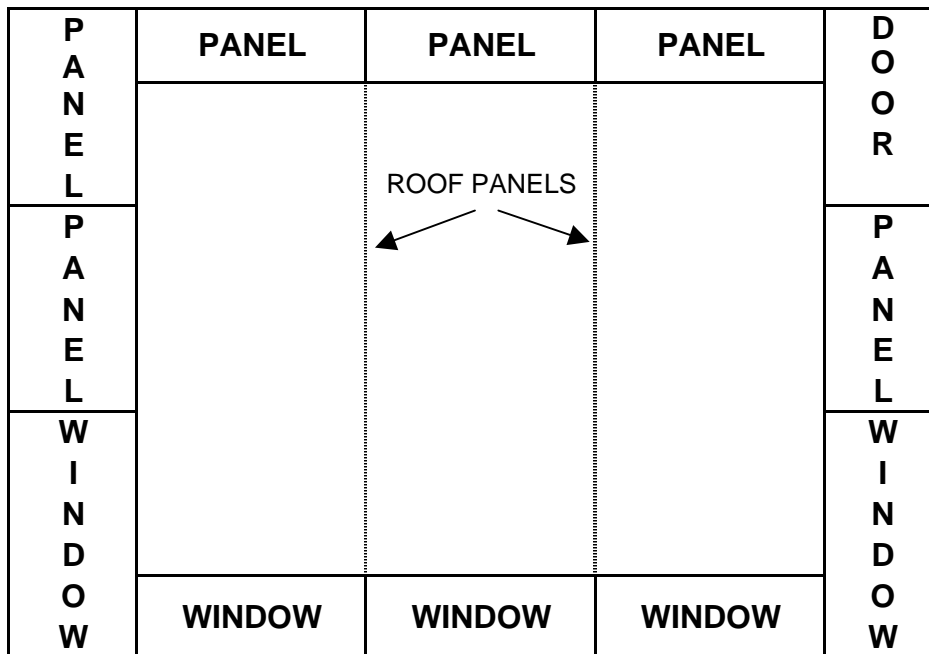

*** NOTE DOOR PANEL CAN BE FIT ON RIGHT OR LEFT SIDE



DESIGN

MULTI-CAISSES



CONFIGURATION

PORTA-PACK TB-0070

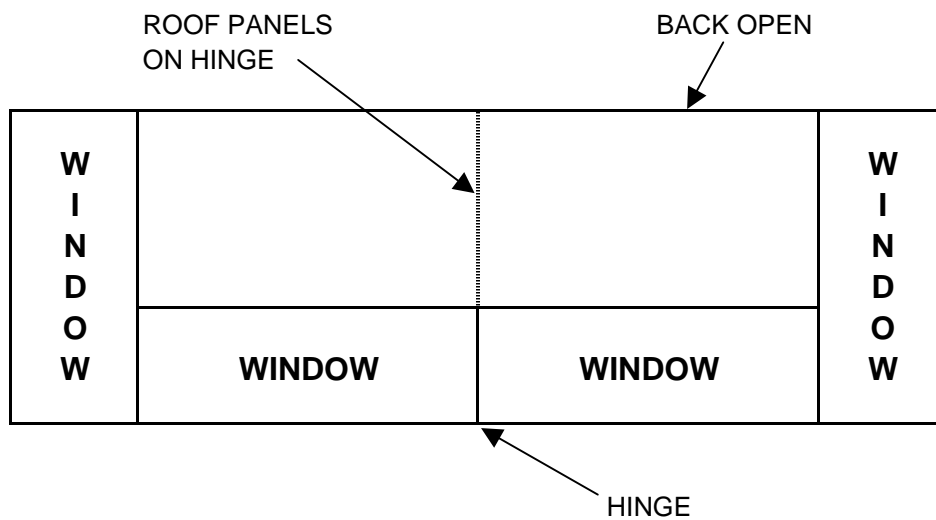

FRONT



*** NOTE DOOR PANEL CAN BE FIT ON RIGHT OR LEFT SIDE